



Directmount crankset

DH / ENDURO
BSA / BB30 / BB92

www.hxrcomponents.com

ATTENTION :

READ CAREFULLY BEFORE INSTALLING YOUR PRODUCT!

Mountain biking is a dangerous sport. It is important to read the instructions completely before installing the product. Ignoring the installation instructions can result in serious injury or death.

GUARANTEE HxR Components

All HxR Components products are guaranteed for 2 years from the date of purchase against manufacturing defects. A purchase invoice will be required for any return request. Any defective product can be returned to its place of purchase or to HxR Components on request by email. The warranty does not cover the consequences of normal wear and tear of the product, failure to comply with the instructions for use or assembly instructions, improper use of the product, a fall, or any modification of the product. This warranty does not affect your legal rights

SPECIFICATION of the product

Depending on the crankset model:

- Crank length: 165 or 170mm
- Through axle: 30mm
- DH axle length: 130mm / Enduro: 115mm

TOOLS you need

- 1 Allen key of 10
- 1 key for your chimney screws
- 1 torque wrench
- Tool for the bottom bracket

CONTENTS of the box

The cranks:

- 1 right crank with axle
- 1 left crank
- 1 tightening screw
- 1 extractor saps
- 1 POM spacer
- 7 POM adjustment spacers (4x0.5 mm / 2x1mm / 1x 0.3 mm wavy spacer)

The chainring :

- 1 directmount chainring
- Spacer depending on the chosen chain line

CHECKS before you start

Make sure you have a bottom bracket for a 30mm axle and that fits the standard of your bike. Check that you have chosen the right chainline for your chainring.

The cranks can only be used with our spider (then the BCD94 chainring of your choice) or our directmount chainring.

We advise you to read the instructions before starting.

The parts must be clean and dry.

If you have any questions, do not hesitate to contact us. You can also have the crankset installed by a professional.

Ready to start ?

INSTALLATION - Follow the guide

A - Directmount chainring - 49mm chainline

Note: Our directmount chainring is only compatible with our HxR Components crankset

- Grease the right crank axle spline.
- First install the 49mm chainline tapered spacer onto the right crank axle spline.
- Install your directmount chainring

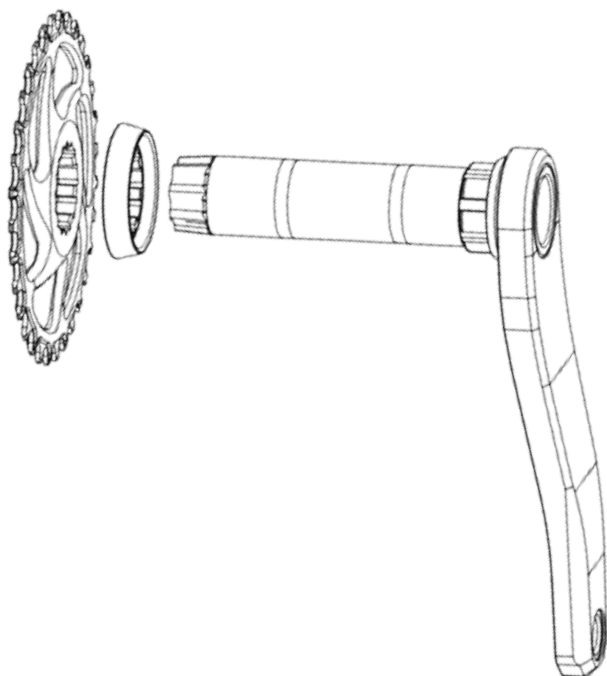

A - Directmount chainring - 52mm chainline

Note: Our directmount chainring is only compatible with our HxR Components crankset

- Grease the right crank axle spline.
- First install the 52mm chainline tapered spacer onto the right crank axle spline.
- Install your directmount chainring
- Put on the 52mm chainline flat spacer.

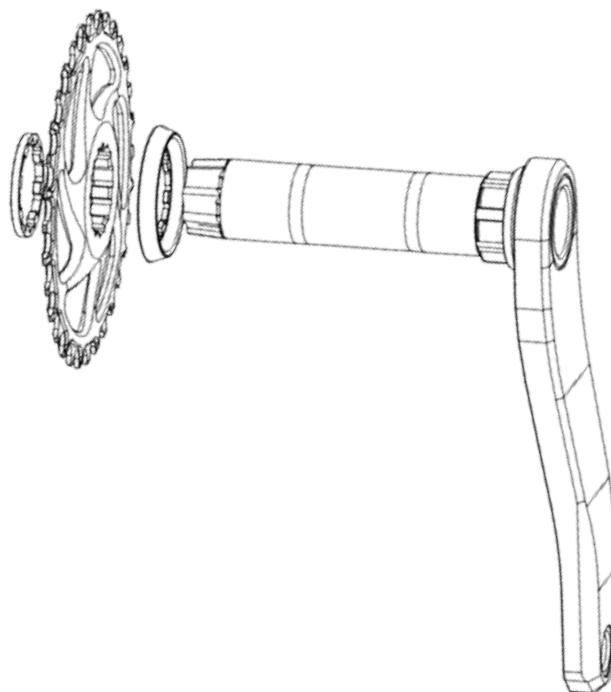

Next step : the bottom bracket
Procedure for a BSA, BB30 or BB92
case. If you have another one, contact
US..

B - Bottom bracket

Note :

- Check the bottom bracket standard of your frame. Our system is compatible with all 30mm axle bottom brackets.
- Below you will find assembly instructions for BSA, BB30 and BB92 bottom brackets. If you have another one and have difficulty mounting our system, please contact us..

BB BSA - 49mm chainline

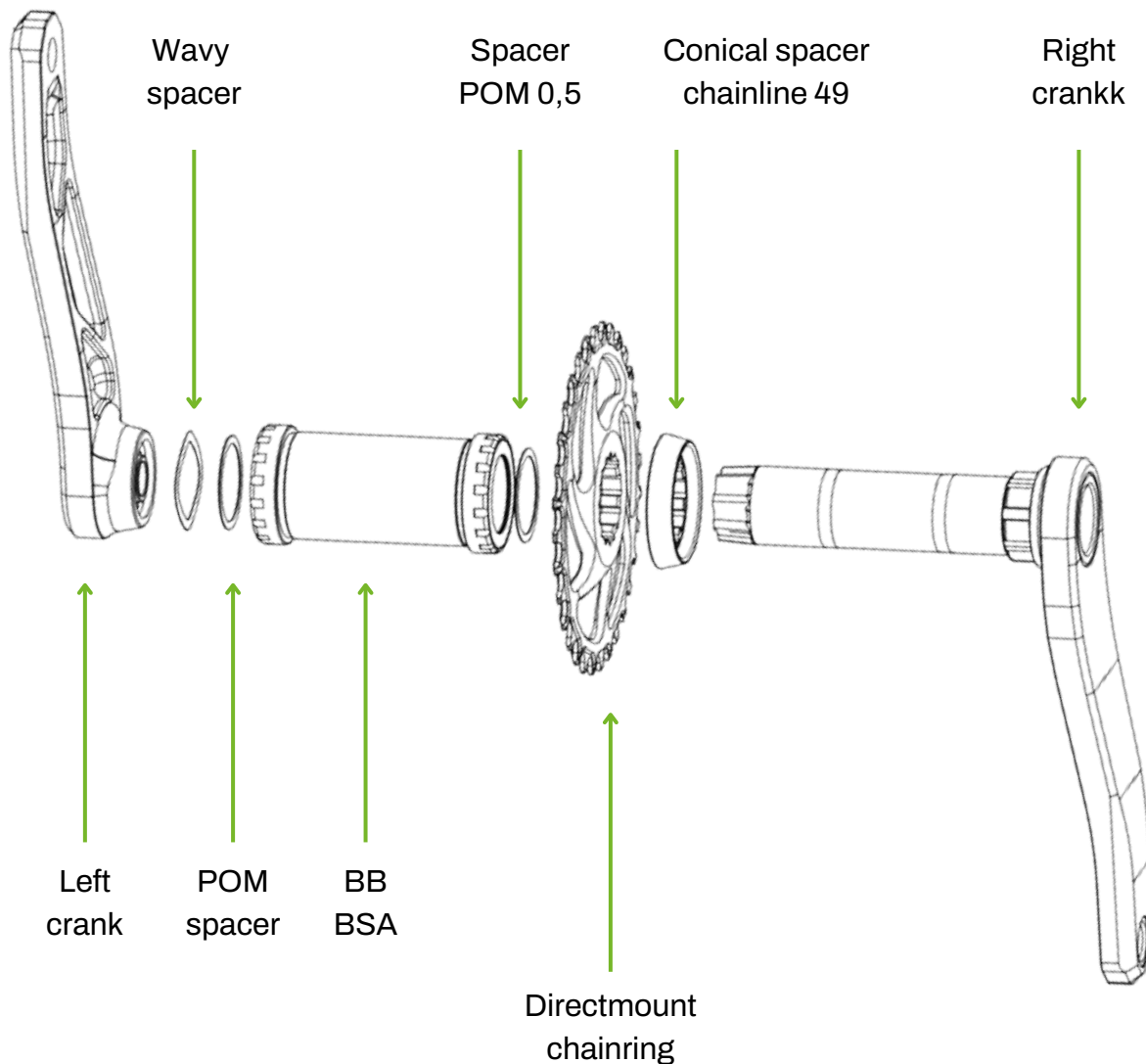

BB BSA - 52mm chainline

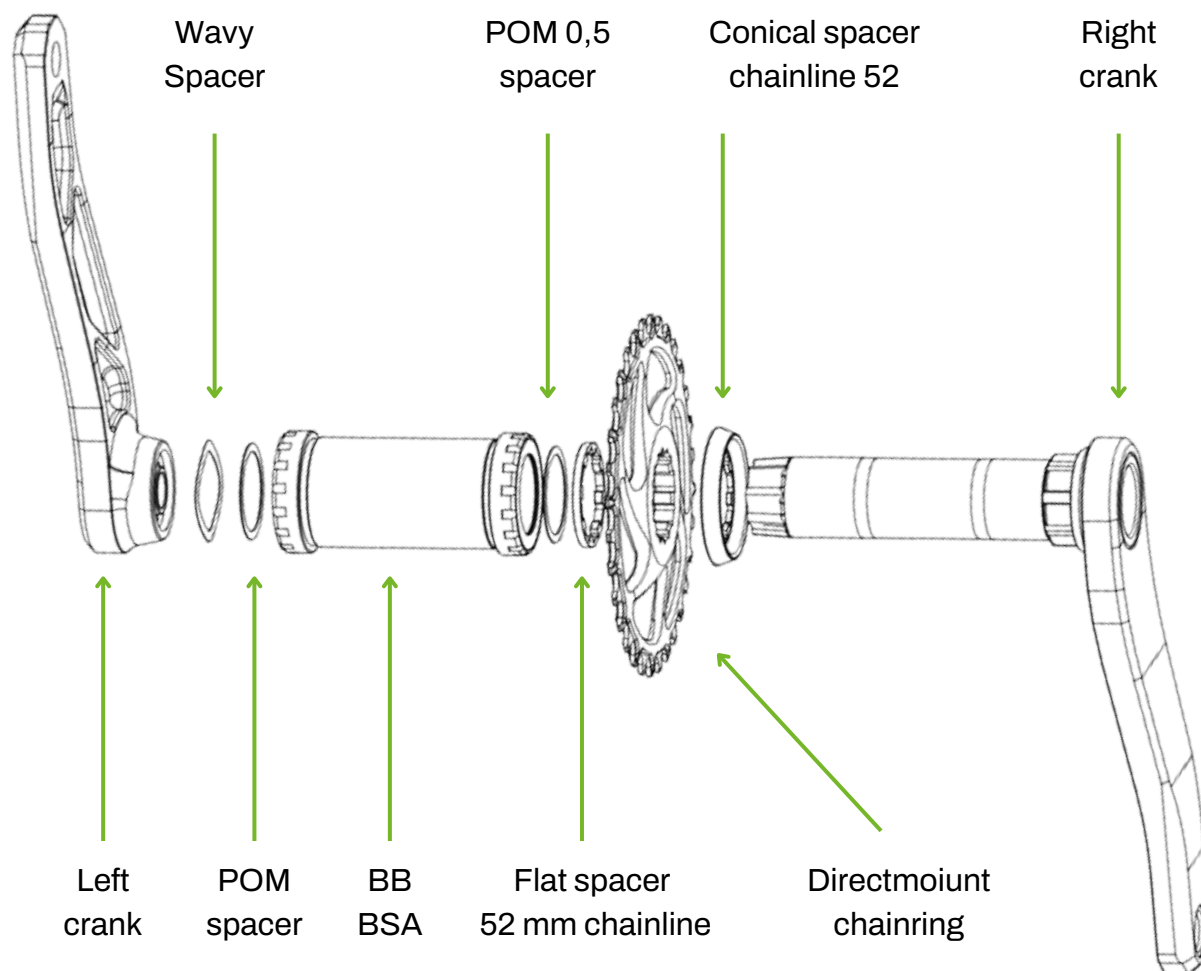

BB BSA

1 - Apply grease to the inside of the frame and to each thread of the housing cups.

1.2 68 mm frame: Add a 2.5 mm washer on both sides.

1.2 73 mm frame: No washer.

1.3 Tighten each cup

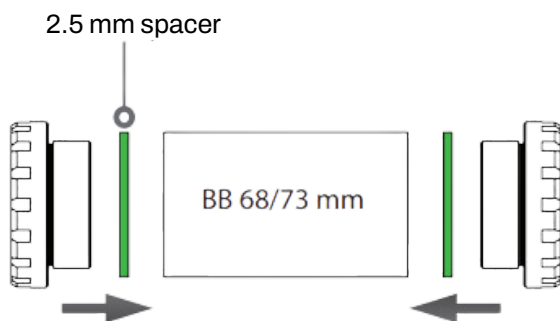

2 - Apply grease to the bottom bracket axle and bottom bracket bearings. Insert a 0.5mm plastic washer against the chainring if in chainline 49, otherwise against the flat spacer of chainline 52 then place the bottom bracket axle inside the bottom bracket.

Be careful, do not use copper grease.

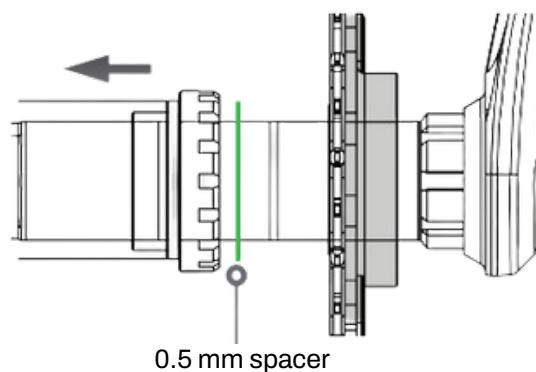

3 - Insert the number of washers (0.5/1mm) needed to adjust the tightness of the bottom bracket. Place the wave washer and tighten the bottom bracket screw until the wave washer becomes flat and the bottom bracket turns freely without any resistance or play.

If you feel resistance, remove a plastic washer.

If the wave washer is not completely flat and there is play in the axle, add as many washers as necessary.

As a reminder, the perfect adjustment is obtained when the crankset turns freely without play and the wave washer is completely flat.

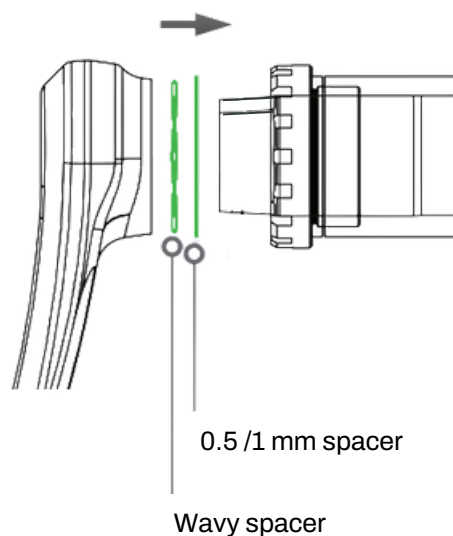

BB30

1 - Check that your bottom bracket is compatible with a 30mm axle

Apply grease to the inside of the frame and to each bearing. Add 1 spacer 12.5mm on the left side and 1 spacer 9.7mm on the right side (delivered with your bottom bracket).

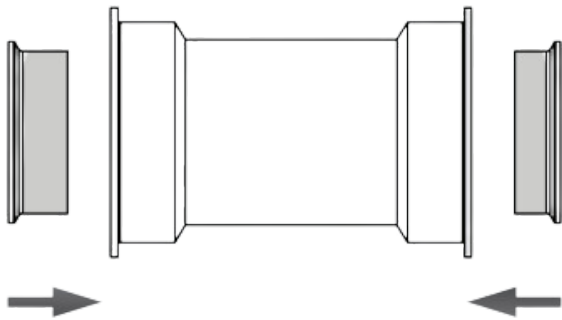

2 - Apply grease to the bottom bracket axle and bottom bracket bearings. Insert the bottom bracket axle into the bottom bracket. Be careful, do not use copper grease.

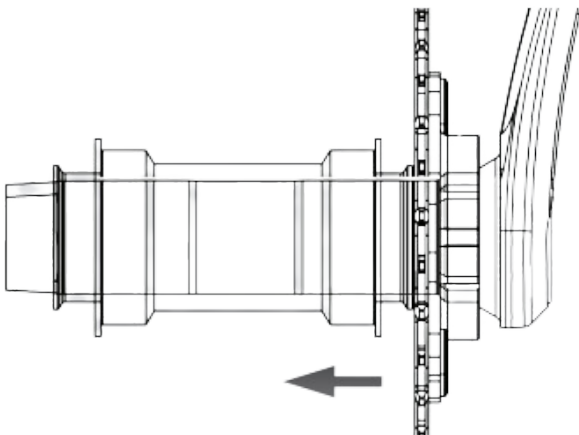

3 - Insert the number of washers (0.5/1mm) needed to perfectly adjust the tightness of the bottom bracket. Insert the wave washer and tighten the bottom bracket screw until the wave washer becomes flat and the bottom bracket turns freely without any resistance or play.

If you feel resistance, remove a plastic washer. If the wave washer is not completely flat and play is felt at the axle, add as many washers as necessary.

As a reminder, the perfect adjustment is obtained when the crankset turns freely without play and the wave washer is completely flat.

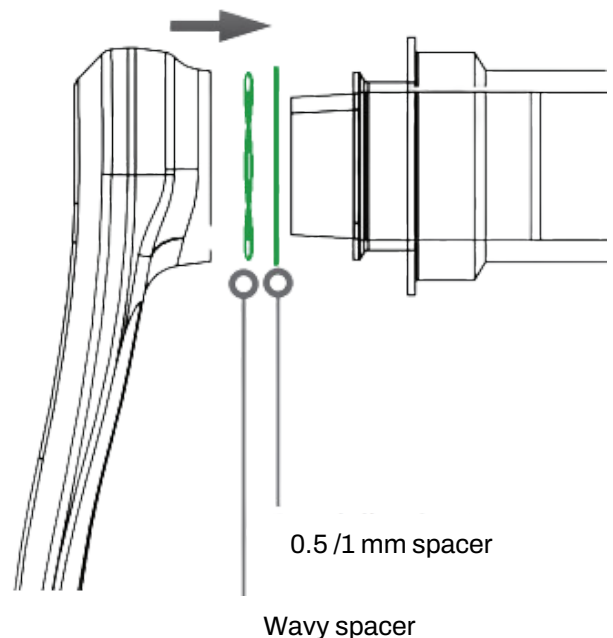

BB92

1 - Check that your bottom bracket is compatible with a 30mm axle

Apply grease to the inside of the frame and to each bearing.

Be careful, do not use copper grease!

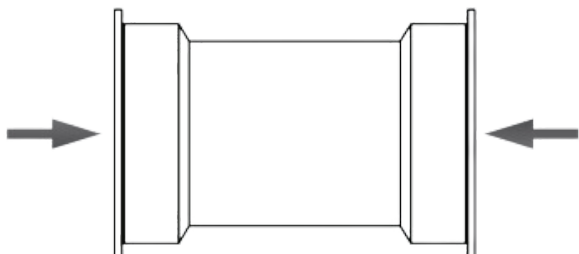

3 - Apply grease to the bottom bracket axle and bottom bracket bearings. Insert a 0.5mm plastic washer against the chainring if in chainline 49, otherwise against the flat spacer of chainline 52 then place the bottom bracket axle inside the bottom bracket.

Be careful, do not use copper grease.

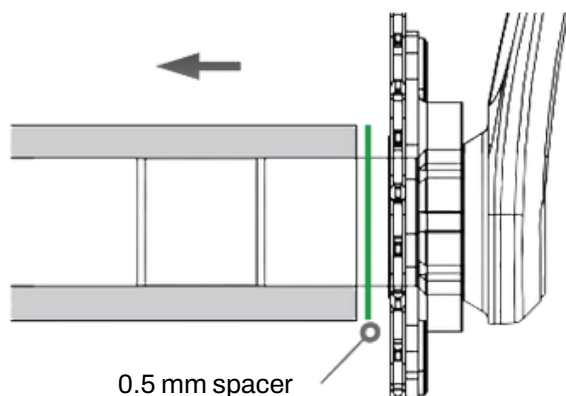

4 - Insert the wave washer and tighten the bottom bracket screw until the wave washer becomes flat and the bottom bracket turns freely without any resistance or play.

If you feel resistance or have difficulty turning the bottom bracket, remove the wave washer.

As a reminder, the perfect adjustment is obtained when the crankset turns freely without play and the wave washer is completely flat.

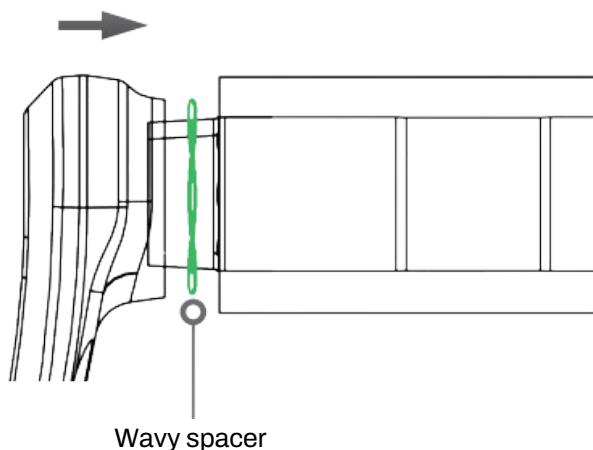

Next step : pedals

C - PÉDALES

1 - Install a washer between the crank and the pedal and tighten the pedal axle to a torque of 47 to 54 N-m.

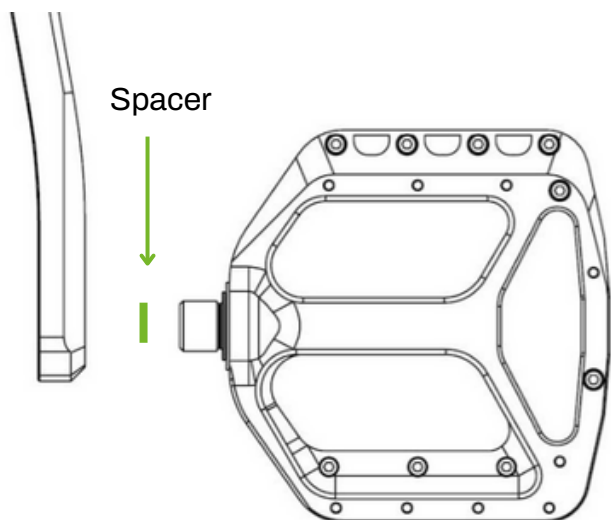

Important reminders.

Never use a lubricant containing penetrating oil.
Never use copper grease, a simple grease is enough.

Do not wash the crankset elements with high-pressure water jets or by immersion.

The use of alkaline or acidic detergents can cause discoloration.

Lubricate your chain regularly.

MAINTENANCE - Tips for longevity

Before your ride

Before each ride, check the following items. If any of them are faulty, do not ride and contact the seller

- Are there any cracks in the crank arms?
- Are the crankset components tightened properly?
- Are the bearing sections securely fastened?
- Are there any abnormal noises?

During your ride

Be careful not to get your clothes caught in the chain while riding to avoid falling or breaking.

After your ride

Use a neutral detergent to clean the crank and bottom bracket elements.

Next step : Ride !

Now, we wish you great mountain biking sessions, have fun and we're counting on you to share your best outings with us!

